

# SUBMITTAL DATA



## P40U SERIES Models: P40U-I P40U-IP P40U-IW

### POSITIVE PRESSURE SERIES GAS FIRED INFRA-RED TUBE HEATERS

PROJECT:			
ENGINEER:			
CONTRACTOR:			
DISTRIBUTOR:			
SCHWANK MODEL #:	P40U -I	P40U-IP	P40U-IW
FUEL:	N.G.	L.P.G.	
APPROVED BY:			
DATE:			
APPROVAL #:			

P40U Series is certified by CSA International to:  
ANSI Z83.20 / CSA 2.34 Standard for Gas-Fired Low Intensity Tube Heaters



[www.Infrasave.com](http://www.Infrasave.com)

**NOTICE:**

Infrasave reserves the right to make changes to equipment and specifications without obligation or notification.

This publication, or parts thereof, may not be reproduced in any form, without prior written consent from Infrasave.  
Unauthorized use or distribution of this publication is strictly prohibited.

Customer and Technical Services

Phone: 1-877-446-3727

Fax: 1-866-361-0523

e-mail: [csr@Infrasave.com](mailto:csr@Infrasave.com)

**[www.Infrasave.com](http://www.Infrasave.com)**

Quantity On Project		
	<b>P40U-I</b>	Indoor Commercial / Industrial; Painted drop-jaw burner housing
		Dimensions: 120" L x 20" W x 12" H (3035 mm x 508 mm x 305 mm)
	<b>P40U-IP</b>	Outdoor / Wet Environments; Powder coated weather tight burner housing
		Dimensions: 124" L x 20" W x 12" H (3150 mm x 508 mm x 305 mm)
	<b>P40U-IW</b>	Outdoor / Harsh Environments; Stainless steel weather tight burner housing
		Dimensions: 124" L x 20" W x 12" H (3150 mm x 508 mm x 305 mm)

<b>All P40U Models:</b> Factory assembled (burner to tube/reflector system)	
<b>Capacity:</b>	40,000 Btuh (12kW) 0 to 4,500 ft. (1,370 m) ABOVE SEA LEVEL
<b>Shipping Weight :</b>	105 lb. (47.6 kg)
<b>Assembly Weight:</b>	96 lb (43.5 kg)
<b>Turbulator:</b>	36" (914 mm) Burner side tube; 90" (2286 mm) Vent side tube
<b>Flue Vent / Air Duct:</b>	4" (102 mm)
<b>Gas Inlet:</b>	1/2" NPT (12.7 mm)
<b>Gas Connector:</b>	USA: 1/2" x 24" Stainless steel - supplied with heater
	Canada: 1/2" x 30" Type 1 Gas Hose - supplied with heater
<b>Manifold Pressure:</b>	3.5" w.c. NG (0.87 kPa); 10" w.c. LPG (2.49 kPa)
<b>Line Minimum:</b>	5" w.c. NG (1.25 kPa); 11" w.c. LPG (2.74 kPa)
<b>Line Maximum:</b>	14" w.c. NG or LPG (3.49 kPa)
<b>Electrical:</b>	120V, 60 HZ 145 VA
<b>Thermostat:</b>	Factory ready for 24Vac or 120Vac thermostat

### CUT-AWAY BURNER VIEW

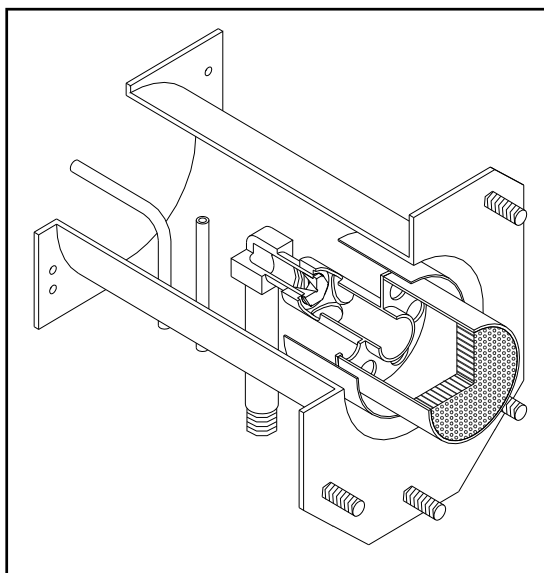

### OPTIONAL ACCESSORIES

		QTY ON PROJECT
FRESH AIR INTAKE WALL HOOD (P40U)	JS-0532-VC	
<i>Fresh Air Hood supplied with P40U-P &amp; P40U-W</i>		
ROOF VENT TERMINAL 102 mm (4")	JA-0530-XX	
ROOF VENT TERMINAL 152 mm (6")	JA-0531-XX	
WALL VENT TERMINAL 102 mm (4")	JA-0528-XX	
WALL VENT TERMINAL 152 mm (6")	JA-0529-XX	
FLUE VENT TEE (102 mm x 102 mm x 152 mm) (4" x 4" x 6")	JA-0514-XX	
COUPLING KIT FOR TEE	JA-0516-SW	
TRU-TEMP 24V SET BACK THERMOSTAT	JM-0150-XX	
24 VOLT DIGITAL THERMOSTAT	JS-0569-WR	
THERMOSTAT 120 VOLT	JL-0772-XX	

## DIMENSIONED VIEW

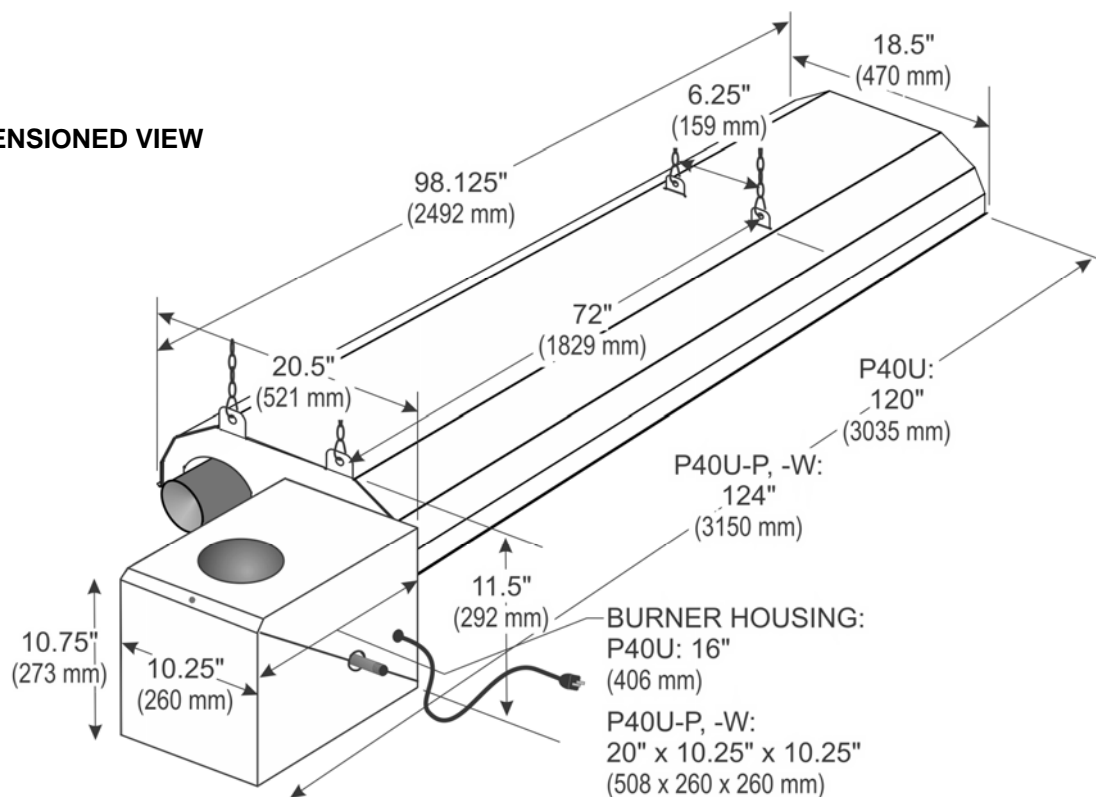

## MINIMUM CLEARANCES TO COMBUSTIBLE SURFACES OR MATERIALS

MODELS	SUSPENDED HORIZONTALLY			SUSPENDED AT AN ANGLE UP TO 30 DEGREES			
	TOP (A) inches (cm)	BELOW (C) inches (cm)	SIDES (S) inches (cm)	TOP (A) inches (cm)	BELOW (C) inches (cm)	FRONT (F) inches (cm)	BEHIND (B) inches (cm)
P40U-I P40U-IP P40U-IW	12 (30.5)	55 (140)	24 (61)	12 (30.5)	55 (140)	36 (91.5)	12 (30.5)
'E': Clearance from 'U' end of heater (horizontal or angled): 24" (61 cm)							

## HORIZONTAL MOUNT

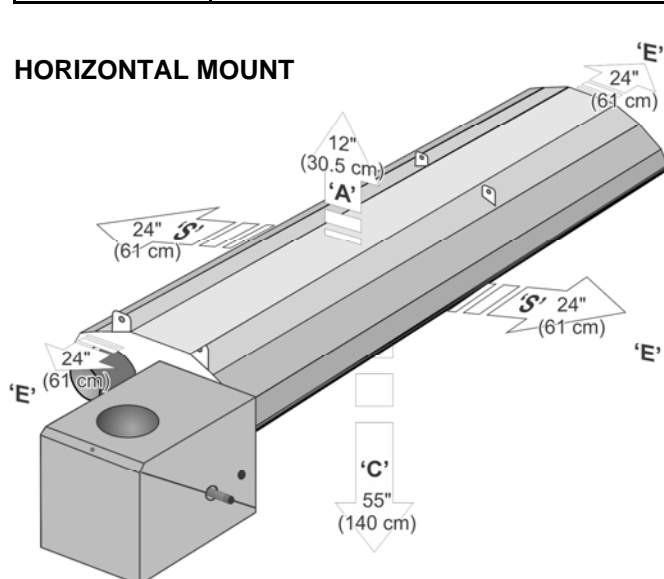

## MOUNTED UP TO 30°

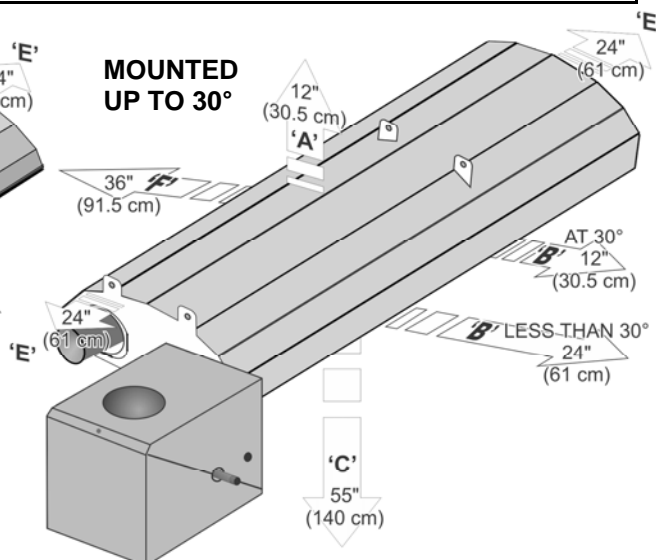

## **COMPONENT DESCRIPTION**

<b>IGNITION</b>	FENWAL DIRECT SPARK MODULE: PRE-PURGE AND POST-PURGE OF TUBE SYSTEM
<b>THERMOSTAT OPTIONS</b>	INFRASAVE TRU-TEMP (24V) SET BACK THERMOSTAT WITH RADIANT & AMBIENT SENSORS, AND AUTOMATIC UNOCCUPIED SETBACK MODE
	24V DIGITAL THERMOSTAT NOTE: MULTIPLE HEATERS PER 24V THERMOSTAT REQUIRE CONTROL CENTER KIT JM-0303-KT
	LINE VOLTAGE THERMOSTAT
	THERMOCONTROL PLUS CONTROLLER
<b>HEATER 'U' TUBE</b>	16 GA. x 4 Inch (102 mm ) DIAMETER ALUMINIZED STEEL SWAGED AT VENT END
<b>COMBINATION GAS VALVE</b>	HONEYWELL 24 VOLT NATURAL GAS: 3.5" w.c. (0.87 kPa) AT MANIFOLD PROPANE GAS: 10" w.c. (2.49 kPa) AT MANIFOLD
<b>REFLECTORS</b>	ALUMINIZED STEEL REFLECTORS ARE CLOSED AT START AND END OF TUBE SYSTEM BY MEANS OF END PLATE HANGERS
<b>HANGERS</b>	EXTEND THROUGH REFLECTOR; SUSPENSION 72" (1829 mm) ON CENTER
<b>BURNER HOUSING</b>	<b>P40U:</b> BOTTOM FOLDS AWAY, PROVIDING ACCESS FROM TWO SIDES, END AND BOTTOM
	<b>P40U-P:</b> POWDER COATED WEATHER TIGHT
	<b>P40U-W:</b> STAINLESS STEEL WEATHER TIGHT
<b>BURNER</b>	INCORPORATES EFFECTILE CERAMIC BURNER HEAD WITH MINIMUM OF 835 GAS/AIR PORTS
	COMPLETE WITH OPERATION STATUS INDICATOR LIGHTS
<b>TRANSFORMER</b>	120/24VAC; 20VA
<b>SAFETY SWITCHES</b>	TWO SEPARATE AIR PRESSURE SWITCHES PROVE ADEQUATE COMBUSTION AIR AND SENSE BLOCKED FLUE
<b>STATUS INDICATOR LIGHTS</b>	GREEN: CALL FOR HEAT; YELLOW: IGNITION TRIAL; RED: FLAME ESTABLISHED
<b>COMBUSTION AIR</b>	COMBUSTION AIR DUCTED DIRECTLY TO INTAKE OF BLOWER
<b>TERMINAL BLOCK</b>	ALL WIRING CONNECTIONS BY MEANS OF COMMON TERMINAL BLOCK; JUMPER: FOR 120V THERMOSTAT; REMOVE FOR 24V THERMOSTAT
<b>ELECTRICAL CORD</b>	1220 mm (4') LENGTH 16/3 ELECTRICAL SUPPLY CORD WITH 3 PIN GROUNDED PLUG